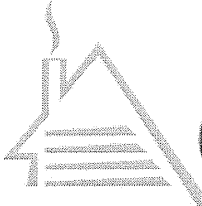

Installation
Manual

Blinds  Chalet

Valencia

**CORDED
Roman Shade**

INSTALLATION INSTRUCTIONS

Mounting hardware kit includes the following:

Part	Quantity
a	Mounting Bracket
	2 (shades up to 29 7/8" wide)
	3 (shades 30" to 47 7/8" wide)
	4 (shades 48" to 72" wide)
B	1 1/8" Screws
	7 (shades up to 29 7/8" wide)
	10 (shades 30" to 47 7/8" wide)
	13 (shades 48" to 72" wide)

Note: one extra screw is included for convenience

Step 2. Tools Required

Pencil, tape measure, screw driver, scissor, step stool, drill.

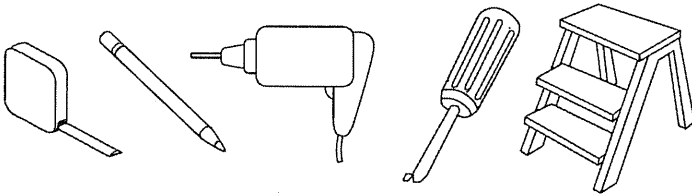

Step 3. Bracket Location and Installation

Your double roman shade may be installed either inside the window frame or outside the window frame.

One mounting bracket should be positioned about 2" to 4" from each end of the head rail. For wider shades that require 3 or 4 brackets, these should be spaced evenly between the two outermost brackets.

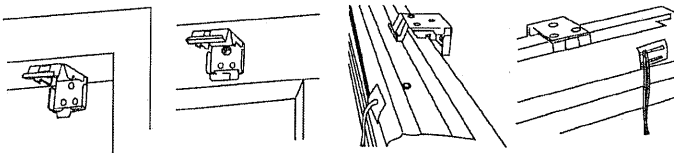

Outside Mounting - Inside Mounting - Head Rail Placement

For Outside Mounting:

Clip the brackets onto the head rail as described above. Hold the shade level at the height desired and center it over the window opening. Mark the exact location of each bracket with a pencil. Remove the brackets from the head rail and position the top of each bracket at the marked location and screw each bracket into the wall or window molding using the 1 1/8" screws.

For Inside Mounting:

Clip the brackets onto the head rail as described above. Hold the shade in place and make a pencil mark at the rear of each bracket where it contacts the inside of the window frame.

Remove the brackets from the head rail and align them with the marks. Attach each bracket using the 1 1/8" screws.

Step 4. Securing the Head Rail

Lift the head rail into position such that the front edge of each bracket is under the inner front edge of the head rail (see illustration). Push the head rail upward until the flexible tab at the bottom of each bracket snaps onto the back of the head rail. Check carefully to assure that each bracket is properly secured.

Step 5. How to Operate

The cords on the right side of the head rail control the front shade. The cords on the left side of the head rail control the rear shade.

To raise or lower either shade, pull the lift cords toward the center of the shade slightly to release the cord lock. Adjust the shade(s) to the desired height, then move the lift cords slightly toward the outside of the shade to lock in place.

Step 6. Valance Attachment

If your shade has a fabric valance, attach it to the Velcro strip on the head rail.

Step 7. Adjust Cord Stop & Cord Length

! WARNING

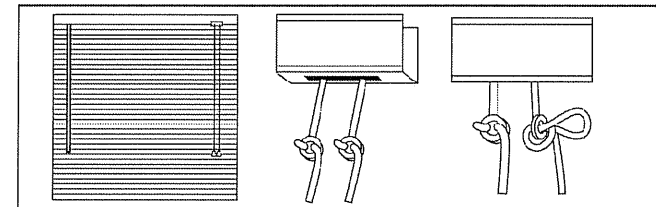

To shorten the lift cords, mark the cords at the desired height. Slide the tassels above this point, tie a new knot in each cord, and then cut off the excess cord. **BE CERTAIN TO ADJUST THE SAFETY CORD STOPS AS DESCRIBED BELOW. REDUCE RISK OF STRANGULATION TO INFANTS AND TODDLERS. POSITION SAFETY CORD STOPS BEFORE USING SHADES.** Lower shade to maximum desired length and lock into place. Measure the distance from head rail to cord stops, if cord stops are 1 to 6" below the head rail, no further adjustment is needed. If not, loosen but do not untie the knot surrounding the cord stop. Move the cord stop as close to the head rail as possible and tighten knot by pulling firmly on tassel. Repeat process for each lift cord.

CLEANING

The head rail can be wiped clean with a damp sponge. To clean the shade fabric, use a feather duster or vacuum lightly using the soft brush or upholstery attachment.

REPLACEMENT PARTS

In the event that replacement parts are ever needed, you may call : 1-888-633-7840

Please provide original order # and description of the part needed.

ONE YEAR LIMITED WARRANTY

I. What is warranted and for how long :

For a period of one(1) year from the date of purchase. Blindschalet.com will replace this window covering with one of equal or superior value, if this window covering is found to be defective in material or workmanship.

II. What is not covered by this Warranty:

This warranty does not cover removal or installation of any window covering.

This Warranty does not cover damage or defects caused by or resulting from improper maintenance, negligent or improper use, abuse, misuse, neglect, accidents, act of God, alteration, commercial use, installation, removal or reinstallation.

This Warranty is restricted to normal consumer use within the United States.

BLINDSCHALET.COM WILL NOT BE LIABLE FOR INCIDENTAL OR CONSEQUENTIAL DAMAGES, SOME STATES DO NOT ALLOW THE EXCLUSION OR LIMITATION OF INCIDENTAL OR CONCEQUENTIAL DAMAGES, SO THE ABOVE LIMITATION OR EXCLUSION MAY NOT APPLY TO YOU.

III. How to obtain warranty service:

To obtain warranty service, please contact Customer Service at #1-888-633-7840 or via e-mail at customerservice@blindschalet.com

WARNING

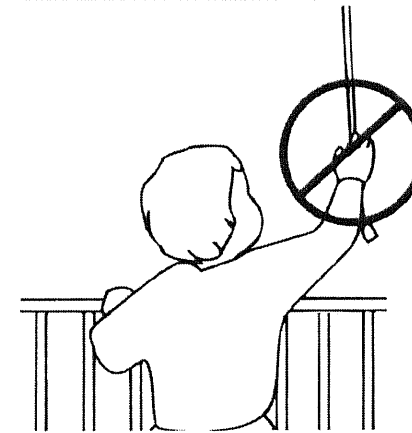

Young children can STRANGLE in cord and bead chain loops. They can also wrap cords around their necks and STRANGLE.

- Always keep cords and bead chains out of children's reach.
- Move cribs, playpens, and other furniture away from cords and bead chains. Children can climb furniture to get to cords.
- Do not tie cords together, Make sure cords do not twist together and create a loop.
- Always ensure that inner cord stop devices are within 6 inches (153 mm) of the head rail when the blind is in the fully lowered position. See adjustment instructions.