

BLISS™ Automation *by* ALTA



15 CHANNEL REMOTE CONTROL PROGRAMMING AND USERS GUIDE

Declarations	2
Motor Charging and Status Indicators	3
Safety Instructions	3
BLISS™ Remote Overview	4
BLISS™ Remote Functions	5
P1 Button Instructions	6
Initial Set-up	7
Adjust Limits	8
Favorite Position	8-9
Add or Remove Additional Remote	9
Adjust Motor Speed	10
Roller or Sheer Mode	10
Quick Index	11
Troubleshooting	11

Declarations

U.S. RADIO FREQUENCY FCC COMPLIANCE

This device complies with Part 15 of the FCC Rules. Operation is subject to the following two conditions:

- (1) This device may not cause harmful interference, and
- (2) This device must accept any interference received, including interference that may cause undesired operation.

This equipment has been tested and found to comply with the limits for a Class B digital device, pursuant to Part 15 of the FCC Rules. These limits are designed to provide reasonable protection against harmful interference in a residential installation. This equipment generates, uses, and can radiate radio frequency energy and, if not installed and used in accordance with the instructions, may cause harmful interference to radio communications. However, there is no guarantee that interference will not occur in a particular installation. If this equipment does cause harmful interference to radio or television reception, which can be determined by turning the equipment off and on, the user is encouraged to try to correct the interference by one or more of the following measures:

- Reorient or relocate the receiving antenna.
- Increase the separation between the equipment and receiver.
- Connect the equipment into an outlet on a circuit different from that to which the receiver is connected.
- Consult the dealer or an experienced radio/TV technician for help.

Any Changes or modifications not expressly approved by the party responsible for compliance could void the user's authority to operate the equipment.

ISED RSS WARNING:

This device complies with Innovation, Science and Economic Development Canada licence-exempt RSS standard(s). Operation is subject to the following two conditions: (1) this device may not cause interference, and (2) this device must accept any interference, including interference that may cause undesired operation of the device. Le présent appareil est conforme aux CNR d'ISED applicables aux appareils radio exempts de licence. L'exploitation est autorisée aux deux conditions suivantes: (1) l'appareil ne doit pas produire de brouillage, et (2) l'utilisateur de l'appareil doit accepter tout brouillage radioélectrique subi, même si le brouillage est susceptible d'en compromettre le fonctionnement.

Motor Charging and Status Indicators

Internal Rechargeable Battery

During operation, if the motor begins to beep, this is an indicator to let users know the motor power is low and needs to be charged. To charge, plug the micro-USB port on the motor into the 5V/2A charger.



Blinking Red:
Low battery alert



Blinking Green:
Charging in process



Solid Green:
Battery has finished charging

External Rechargeable Battery Pack

During operation, if the voltage is detected to be too low, the battery stops running and needs to be recharged. To charge, plug the micro-USB port on the end of the battery pack into the 5V/2A charger.



Solid Red:
Charging in process



Solid Green:
Battery has finished charging

Safety Instructions

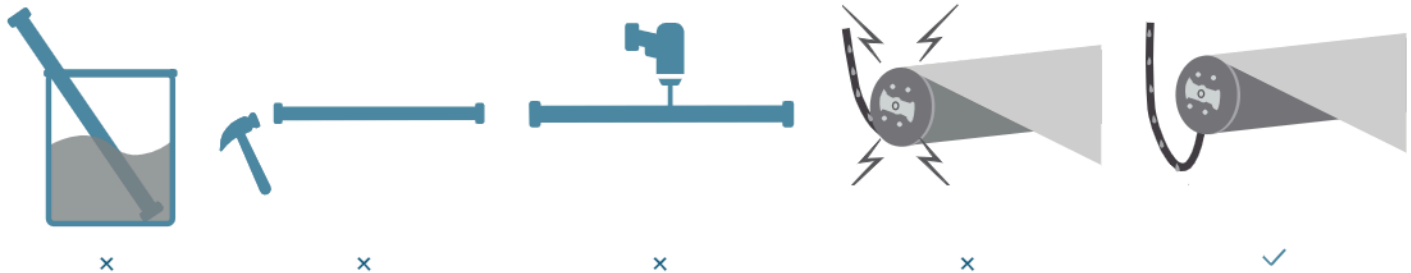

Attention

- Never drop, knock, drill or submerge the motor. Keep the power cable in the proper position as shown below.
- Read all safety instructions before installation.
- Incorrect installation can lead to serious injury and will void manufacturer's liability and warranty.



Important Safety Instructions

1. Do not expose motor to humid, damp, or extreme temperature conditions.
2. Do not drill into motor.
3. Do not cut the antenna. Keep it clear from metal objects.
4. Do not allow children to play with this device.
5. If the power cable or connector is damaged, do not use.
6. Ensure the power cable and aerial is clear and protected from moving parts.
7. Cable routed through walls should be properly isolated.
8. Motor is to be mounted in horizontal position only.
9. Before installation, remove unnecessary cords and disable equipment not needed for powered operation.
10. Installation and programming should be performed by a qualified professional. Use or modification outside the scope of these instructions may void warranty.

  Do not dispose of in general waste.
Please recycle batteries and damaged electrical products appropriately.

BLISS Remote Overview

1. Available Products



Dual Shades



Faux / Wood Tilt-Only



Honeycomb Shades

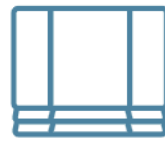

Natural Wovens



Roller Shades



Window Shadings

2. Specifications

Voltage	3V
Radio Frequency	433.92 MHz Bi-directional
Transmitting Power	10 milliwatt
Operating Temperature	14°F to 122°F (-10°C to 50°C)
RF Modulation	FSK
Lock Function	Yes
IP Rating	IP20
Transmission Distance	up to 200m (outdoor)

3. Remote Button Instructions

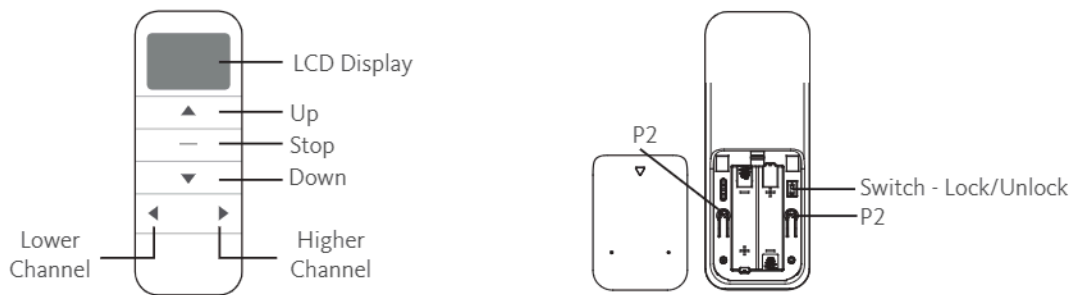

4. Replace/Install Batteries

- Gently press down the cover and slide it off.
- Install batteries (2AAA) paying attention to the polarity position.
- Slide the cover back onto the backside of the remote.

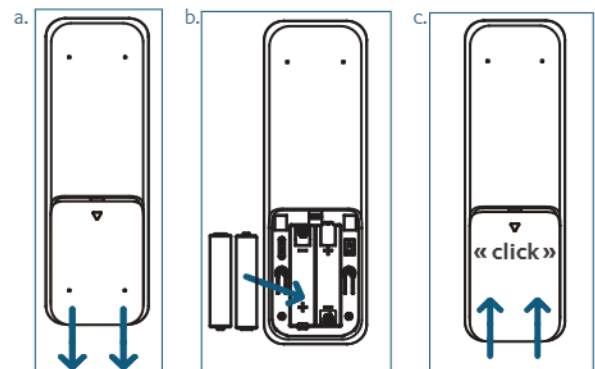

BLISS Remote Function

1. Channel Options

Select A Channel

NOTE: Channel “O” controls all shades/blinds.

a. Press “<” button on the remote to select a lower channel.

b. Press “>” button on the remote to select a higher channel.

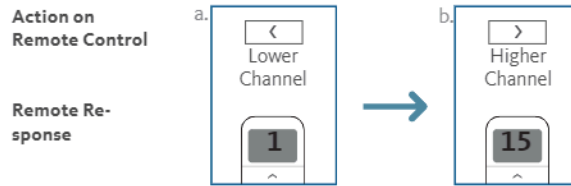

Hide Unused Channels

a. Press and Hold “<” and “>” buttons simultaneously (remote control will display “C”, continue to hold (about 3 sec) until channel 15 is displayed.

b. Press “<” or “>” button to select the last channel you want displayed. (For example; if you only want 5 channels, select 5 as your last channel, between 1 to 15).

c. Press “Stop” button to confirm selection (the example shows a 5-channel selection). The LED will display “O” (OK) once to confirm selection.

* To unhide the channels, repeat the above steps except, select 15 as your last channel on Step b. Press “Stop” button to confirm selection (the example shows a 5-channel selection). The LED will display “O” (OK) once to confirm selection.

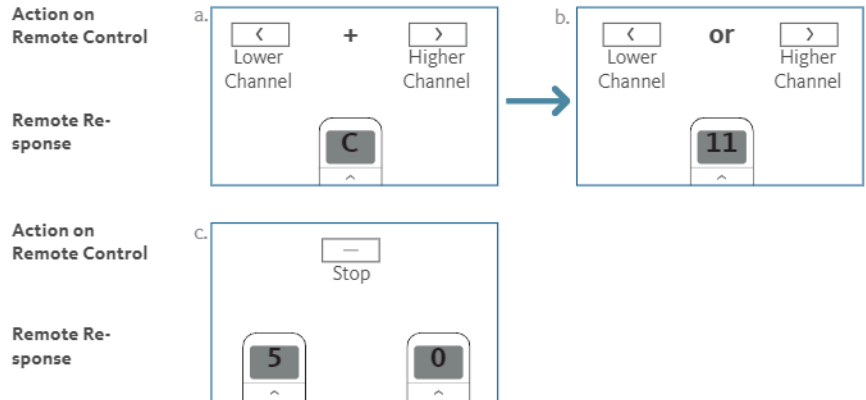

2. Advanced Setting - Disable Limit Setting

a. Remove the cover from the backside of remote, the lock switch is in the right corner.

b. Move the switch to the “Lock” position to disable the following commands, remote will show “L” (lock):

- Change Motor Direction
- Setting the Upper and Lower Limit
- Adjust Limit
- Roller Mode or Sheer Mode

c. Move the switch to “Unlock” position to assess all remote functions, remote will show “U” (unlock).

*This advanced feature is intended to be used after all shade programming is completed. User Mode will prevent accidental or unintended changing of limits.

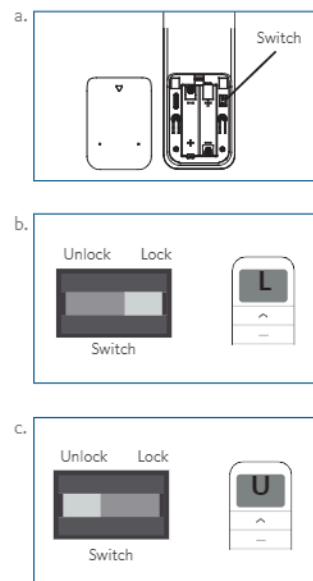

P1 Button Instructions

2. P1 Button Location

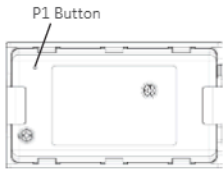

BLISS TILT
Faux/Wood

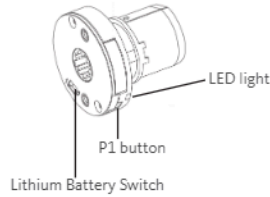

BLISS 1.1 and BLISS 2.0
Dual/Natural Woven/Roller/Window Shadings

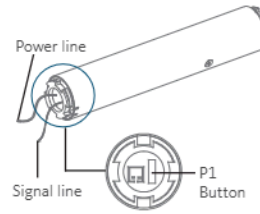

BLISS LIFT
Honeycomb

2. P1 Button Instruction

① Test Motor

Happens as you press for 1 second



Press P1
Less than 1 sec.

when released

Motor Response: Wakes & Runs

② Activate Pairing Mode

Happens as you press for 2 seconds



Press P1
Approx. 2 sec.

Until Shade: Jog x1

when released

Motor Response: Beep x1

③ Sleep Mode

Happens as you press for 6 seconds



Press P1
Approx. 6 sec.

Until Shade: Jog x2

when released

Motor Response: Beep x2

④ Reverse Direction

Happens as you press for 10 seconds



Press P1
Approx. 10 sec.

Until Shade: Jog x3

when released

Motor Response: Beep x3

⑤ Reset To Factory Settings

Happens as you press for 14 seconds



Press P1
Approx. 14 sec.

Until Shade: Jog x4

when released

Motor Response: Beep x4

BLISS Lift and BLISS Tilt motors do not beep

Initial Set-up

1. Pair / Unpair Remote Control

a. Press **“P1”** button (about 2 sec) on the motor head until motor jogs x1 and beeps x1.

b. In the next 10 secs, press and hold **“Stop”** button on the remote control until motor jogs x2 and beeps x3.

Quick Pairing Tip for BLISS Lift Honeycomb motors:

Plug in external battery pack and press and hold **“Stop”** button on remote within 10 seconds.

* Repeat the same procedure to unpair remote control.

BLISS Lift and BLISS Tilt motors DO NOT Beep

Action on Motor

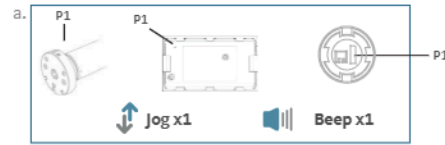

Motor Response

Action on Remote Control



Motor Response

2. Change Motor Direction (if necessary)

Press **“Up”** or **“Down”** button to check if the shade moves in the desired direction.

If you need to reverse the direction, press and hold (about 2 sec) **“Up”** and **“Down”** buttons simultaneously until motor jogs x1 and beeps x1.

Action on Remote Control



Motor Response

*The operation is only valid when there are no limits. If the motor has already set the upper and lower limit, then you can only switch direction by pressing P1 button (See P1 button instructions).

3. Setting the Upper and Lower Limits

Set Upper Limit

a. Press **“Up”** button to raise the shade, then press **“Stop”** button when it is in the desired upper limit.

b. Press and hold (about 5 sec) **“Up”** and **“Stop”** buttons simultaneously until motor jogs x2 and beeps x3.

Action on Remote Control

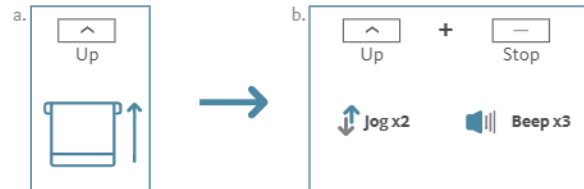

Motor Response

Set Lower Limit

a. Press **“Down”** button to lower the shade, then press **“Stop”** button when it is in the desired lower limit.

b. Press and hold (about 5 sec) **“Down”** and **“Stop”** buttons simultaneously until motor jogs x2 and beeps x3.

Action on Remote Control

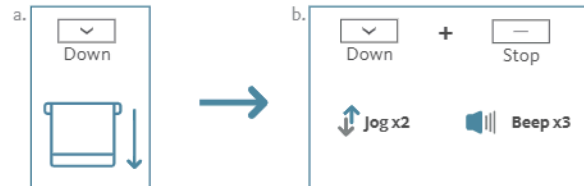

Motor Response

*If you exit the limit setting status before you finish the limit settings, the motor will take the previous existing limits.

Adjust Limits

1. Adjust the Upper Limit

a. Press and hold (about 5 sec) **“Up”** and **“Stop”** buttons simultaneously until motor jogs x1 and beeps x1.

b. Use **“Up”** button to raise the shade to the desired highest position, and use **“Up”** or **“Down”** button to do the final adjustment if necessary.

c. Press and hold (about 5 sec) **“Up”** and **“Stop”** buttons simultaneously until motor jogs x2 and beeps x3.

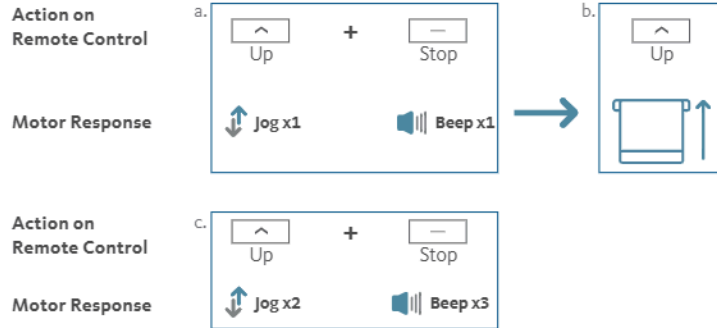

2. Adjust the Lower Limit

a. Press and hold (about 5 sec) **“Down”** and **“Stop”** buttons simultaneously until motor jogs x1 and beeps x1.

b. Use **“Down”** button to lower the shade to the desired lowest position, and use **“Up”** or **“Down”** button to do the final adjustment if necessary.

c. Press and hold (about 5 sec) **“Down”** and **“Stop”** buttons simultaneously until motor jogs x2 and beeps x3.

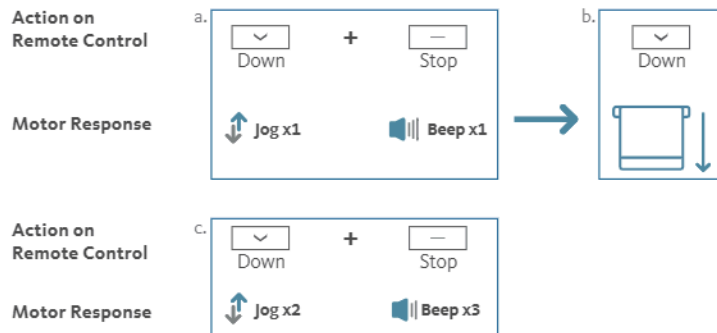

Favorite Position

1. Set Favorite Position

a. Use **“Up”** or **“Down”** button to move the shade to desired Favorite position.

b. Press and hold (about 2 sec) one **“P2”** button on the back of remote control until motor jogs x1 and beeps x1.

c. Press and hold (about 2 sec) **“Stop”** button until motor jogs x1 and beeps x1.

d. Once more, press and hold (about 2 sec) **“Stop”** button until motor jogs x2 and beeps x3.

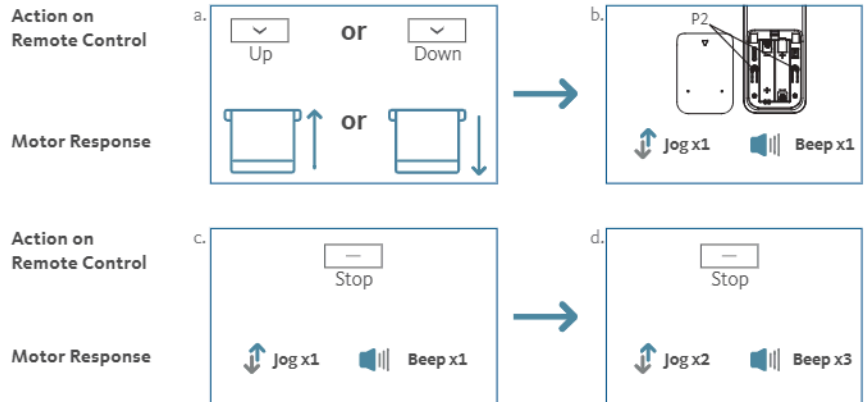

2. Send Shade to Favorite Position

Press and hold (about 2 sec) **“Stop”** button, motor will move to Favorite position.

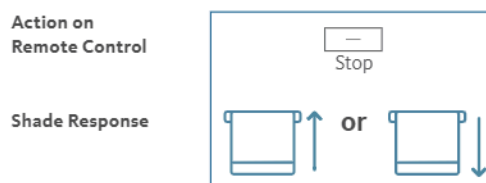

Favorite Position

3. Delete Favorite Position

- Press and hold (about 2 sec) one “P2” button until motor jogs and beeps x1.
- Press and hold (about 2 sec) “Stop” button until motor jogs and beeps x1.
- Once more, press and hold (about 2 sec) “Stop” button until motor jogs x1 and long beeps x1.

Action on Remote Control

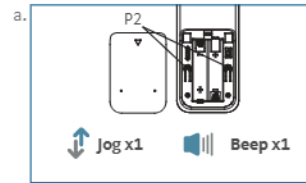

Motor Response

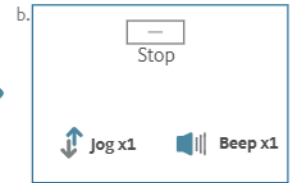

Action on Remote Control

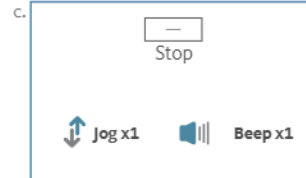

Motor Response

Add or Remove Additional Remote

1. Using Current Remote Control

Start by selecting the Channel on the current remote control that you would to copy to the New remote control.

- On the **current** remote control, press and hold (about 2 sec) one “P2” button until motor jogs x1 and beeps x1.
- Once more, on the **current** remote control, press and hold (about 2 sec) one “P2” button until motor jogs x1 and beeps x1.
- On the **New** remote control, press and hold (about 2 sec) one “P2” button until motor jogs x2 and beeps x3.

***Repeat the same procedure to copy additional channels on the New remote control.**

Action on Remote Control

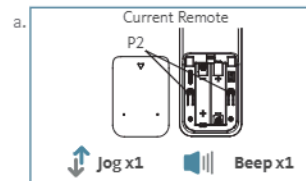

Motor Response

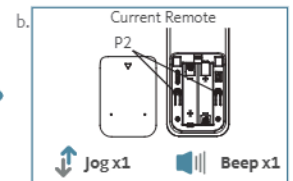

Action on Remote Control

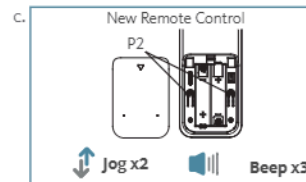

Motor Response

2. New Remote Control

Follow instructions under the section **Pair / Unpair Remote Control**

Adjust Motor Speed

1. Acceleration Speed

- Press one **"P2"** button until motor jogs x1 and beeps x1.
- Press **"Up"** button until motor jogs x1 and beeps x1.
- Once more, press **"Up"** button until motor jogs x2 and beeps x1.

Action on Remote Control

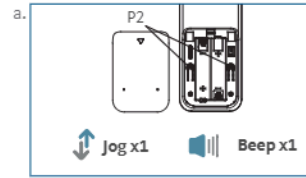

Motor Response

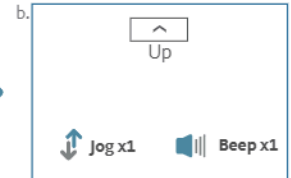

Action on Remote Control



Motor Response

2. Deceleration Speed

- Press one **"P2"** button until motor jogs x1 and beeps x1.
- Press **"Down"** button until motor jogs x1 and beeps x1.
- Once more, press **"Down"** button until motor jogs x2 and beeps x1.

Action on Remote Control

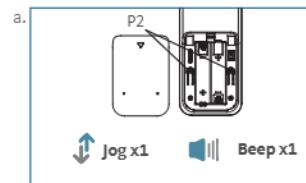

Motor Response

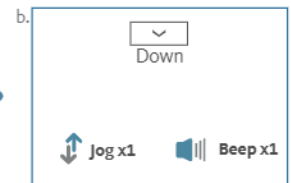

Action on Remote Control



Motor Response

*If the motor has no response, it already has a Maximum or Minimum speed.

Roller or Sheer Mode

1. Roller Shade Mode - continue movement after a short press - Default Mode

- Press and hold (about 5 sec) **"Up"** and **"Down"** buttons simultaneously until motor jogs x1.
- Press and hold (about 2 sec) **"Stop"** button until motor jogs x2 and beeps x3.

Action on Remote Control



Motor Response

Action on Remote Control

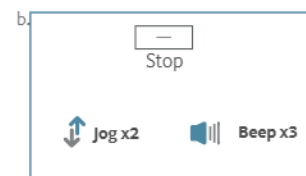

Motor Response

2. Sheer Shade Mode - jog movement after a short press (continue movement after a long press)

- Press and hold (about 5 sec) **"Up"** and **"Down"** buttons simultaneously until motor jogs x1.
- Press and hold (about 2 sec) **"Stop"** button until motor jogs x1 and beeps x1.

Action on Remote Control

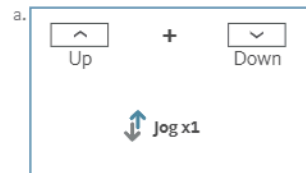

Motor Response

Action on Remote Control



Motor Response

Quick Index

Settings	Steps
1 Pairing	P1 (hold down for 2s) > Stop (hold down for 2s)
2 Switch Rotating Direction	Up + Down (hold down for 2s)
3 Setting Upper & Lower Limits	Upper Limit: Up (hold down for 2s) > Up + Stop (hold down for 2s) Lower Limit: Down (hold down for 2s) > Down + Stop (hold down for 2s)
4 Add / Remove Favorite Position	P2 > Stop > Stop
5 Roller Mode & Sheer Mode Switch	Up + Down (hold down for 5s) > Stop
6 Adjust Limits	Upper Limit: Up + Stop (hold down for 5s) > Up or Down > Up + Stop (hold down for 2s) Lower Limit: Down + Stop (hold down for 5s) > Up or Down > Down + Stop (hold down for 2s)
7 Pair / Unpair Additional Emitter	P2 (existing) > P2 (existing) > P2 (new)
8 Speed Regulation	Acceleration: P2 > Up > Up Deceleration: P2 > Down > Down

Troubleshooting

Issues	Possible Causes	Solution
The motor has no response	Battery in motor is depleted	Recharge with provided charger and/or check connection and positioning of solar panel
	Insufficient charging from Solar Panel	Check connection and orientation of solar panel
	Remote control batteries are dead	Replace batteries
	Batteries are not inserted correctly	Check battery polarity
	Radio interference / shielding	Keep remote control and motor antenna away from metal objects
	Receiver too far from Remote Control	Move remote control to a closer position
	Power failure	Check power supply to motor is connected and active
	Incorrect wiring	Check that wiring is connected correctly
Motor beeps 10 times when in use	Battery voltage is low / PV (solar panel issue)	Recharge with provided charger and/or check connection and positioning of solar panel
Cannot program a single motor (multiple motors respond)	Multiple motors are paired to the same channel.	Always reserve an individual channel for programming functions
		SYSTEM BEST PRACTICE - Provide an extra remote control for multi-motor projects that provides individual control for each motor for programming purposes
		Place all other motors into sleep mode (ref to P1 button instructions)